

MODEL SS-8X STAINLESS STEEL HEAVY DUTY FLEXIBLE COUPLING

The Model SS-8X is designed for high pressure applications including reverse osmosis and desalination systems. The SS-8X is available in stainless steel 304, stainless steel 316, Duplex CD3MN (2205), Super Duplex CE8MN, CE3MN (2507) and 6-Moly stainless steel CK3MCuN (254SMO). The SS-8X features 304 or 316 bolts, washers and Silicon Bronze nuts to help prevent galling during repetitive use.

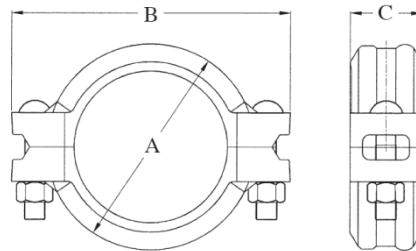

SS-8X couplings should always be installed so that the coupling bolt pads make metal to metal contact.



Full warranty terms can be found on www.shurjoint.com

Model SS-8X Stainless Steel Heavy Duty Flexible Coupling											
Nominal Size	Pipe OD	Max. Working Pressure (CWP)*	Max. End Load	Axial Displacement †	Dimensions			Deflection Degree†	Bolt Size	Weight	
					A	B	C				
in mm	in mm	PSI Bar	Lbs kN	in mm	in mm	in mm	in mm	(°)	No	in Kgs	
¾ 20	1.050 26.7	1400 98	1212 5.39	0 - 0.06 0 - 1.6	2.20 56.0	3.75 95.0	1.81 46.0	3° - 23'	2	¾ x 2½ 0.7	1.5
1 25	1.315 33.4	1400 98	1900 8.45	0 - 0.06 0 - 1.6	2.45 63.0	3.91 99.0	1.81 46.0	2° - 45'	2	¾ x 2½ 0.8	1.8
1¼ 32	1.660 42.2	1400 98	3028 13.47	0 - 0.06 0 - 1.6	2.82 72.0	4.37 111.0	1.81 46.0	2° - 10'	2	¾ x 2½ 0.9	2.0
1½ 40	1.900 48.3	1400 98	3967 17.65	0 - 0.06 0 - 1.6	3.06 78.0	4.82 123.0	1.81 46.0	1° - 54'	2	¾ x 2½ 1.0	2.2
2 50	2.375 60.3	1400 98	6199 27.58	0 - 0.06 0 - 1.6	3.46 88.0	5.28 134.0	1.85 47.0	1° - 31'	2	¾ x 2½ 1.2	2.6
2½ 65	2.875 73.0	1400 98	9084 40.41	0 - 0.06 0 - 1.6	6.02 153.0	4.06 103.0	1.85 47.0	1° - 15'	2	¾ x 2½ 1.3	2.9
3 80	3.500 88.9	1400 98	13463 59.89	0 - 0.06 0 - 1.6	4.71 120.0	6.74 171.0	1.85 47.0	1° - 02'	2	½ x 3 1.8	4.0
4 100	4.500 114.3	1400 98	22255 99.00	0 - 0.13 0 - 3.2	5.98 152.0	7.90 201.0	2.03 52.0	1° - 36'	2	½ x 3 2.4	5.3
5 125	5.563 141.3	1000 70	24293 108.07	0 - 0.13 0 - 3.2	7.13 181.0	9.80 249.0	2.09 53.0	1° - 18'	2	¾ x 3½ 3.5	7.7
6 150	6.625 168.3	1000 70	34454 153.27	0 - 0.13 0 - 3.2	8.19 208.0	10.85 276.0	2.09 53.0	1° - 05'	2	¾ x 3½ 4.0	8.8
8 200	8.625 219.1	1000 70	58397 259.77	0 - 0.13 0 - 3.2	10.53 267.0	13.43 341.0	2.44 62.0	0° - 50'	2	¾ x 4¾ 6.8	15.0
200 JIS	8.516 216.3	1000 70	56930 253.25	0 - 0.13 0 - 3.2	10.39 264.0	13.31 338.0	2.44 62.0	0° - 51'	2	¾ x 4¾ 6.5	14.3

* The working pressure shown is based on cut-grooved Sch. 40S or 80S pipe. For other pipe schedules and roll-grooved pipe, see the below table on page 2.
 † Axial Displacement and deflection figures are for roll grooved standard weight stainless steel pipe. Values for cut grooved pipe will be double that of roll grooved. These values are maximums; for design and installation purposes these figures should be reduced by: 50% for ¾"/DN20 - 3½"/DN90; 25% for 4"/DN100 and larger to compensate for jobsite conditions.

Performance Data

The following tables show maximum cold working pressures (CWP) of **Shurjoint** stainless steel couplings used on stainless steel pipes.

In general it is more difficult to achieve defined groove corners on stainless steel pipe than on carbon steel pipe. Always select the correct roll set for the pipe being grooved and process grooves as defined as possible. Contact your roll-groove tool manufacturer for recommendations.

Model SS-8X Heavy Duty Flexible Coupling				
Nom. Size in / mm	Cut-Grooved	Roll-Grooved		
	Sch. 40S PSI / Bar	Sch. 40S PSI / Bar	Sch. 10S PSI / Bar	Sch. 5S PSI / Bar
1 25	1400 98	750 52	500 35	325 22
1¼ 32	1400 98	750 52	500 35	325 22
1½ 40	1400 98	750 52	500 35	325 22
2 50	1400 98	750 52	500 35	325 22
2½ 65	1400 98	750 52	500 35	325 22
3 80	1400 98	750 52	500 35	325 22
4 100	1400 98	750 52	400 28	250 17
5 125	1000 70	300 20	200 14	125 9
6 150	1000 70	300 20	200 14	125 9
8 200	1000 70	300 20	125 14	125 9

Proof test pressure: 1.5 times the listed working pressure.

Burst pressure: 3 times the listed working pressure.

MATERIAL SPECIFICATIONS

• Housing:

Super duplex 2507 (CE3MN) to ASTM A890 Grade 5A

- Duplex 2205 (CD3MN) to ASTM Grade 4A
- Austenitic 254SMO (CK3MCuN) to A743
- Type 304 Stainless steel to ASTM A351 CF8 or A743 Gr. CF8
- Type 316 to ASTM A743 CF8M

• Rubber Gaskets:

Grade "E" EPDM (Color code: Green stripe) Good for cold & hot water up to +230°F (+110°C). Also good for services for water with acid, water with chlorine, deionized water, seawater and waste water, dilute acids, oil-free air and many chemicals.

Not recommended for petroleum oils, minerals oils, solvents and aromatic hydrocarbons.

Maximum Temperature Range: -30°F (-34°C) to +230°F (+110°C)*.

*EPDM gaskets for water services are not recommended for steam services unless couplings or components are accessible for frequent gasket replacement.

- (Option) Grade "T" Nitrile (Color code: Orange stripe) Recommended for petroleum products, air with oil vapors, vegetable and mineral oils within the specified temperature range. Also good for water services under +150°F (+66°C).

Temperature range: -20°F to +180°F (-29°C to +82°C).
Do not use for HOT WATER above +150°F (+66°C) or HOT DRY AIR above +140°F (+60°C)

- Other options: Grade "O" Fluoroelastomer.
Grade "L" Silicone.
For additional details contact **Shurjoint**.

• Bolts:

Type 304 or 316 stainless steel track bolts to ASTM A193 B-8M, Molybdenum disulfide (MoS₂) coated

• Nuts:

Silicon bronze heavy duty nuts to ASTM B98 C65100

General Notes:

- **Maximum Working Pressure (CWP)** listed is the maximum cold water pressure for general piping services tested to ASTM F1476 and or AWWA C606 methods. Figures listed are based on roll- or cut-grooved standard wall stainless steel pipe. For other pipe schedules or pipe materials, contact **Shurjoint** for additional information.
- **Max. End Load** is calculated based on the maximum working pressure (CWP).
- **Field Joint Test:** For one time only the system may be tested hydrostatically at 1½ times the maximum working pressure listed (AWWA C606 5.2.3).
- **Warning:** Piping systems must always be depressurized and drained before attempting disassembly and or removal of any components.
- **The 10 Year Limited Warranty** applies to manufacturing defects only and does not cover severe service/temperature applications or wear parts.
- **Shurjoint** reserves the right to change specifications, designs and or standard without notice and without incurring any obligations.

Job Name:	System No.	Location:
Contractor:	Approved:	Date:
Engineer:	Approved:	Date:

Shurjoint product specifications in U.S. customary units and metric are approximate and are provided for reference only. For precise measurements, please contact **Shurjoint** Technical Service. **Shurjoint** reserves the right to change or modify product design, construction, specifications, or materials without prior notice and without incurring any obligations to make such changes and modifications on **Shurjoint** products previously subsequently sold.