

MODEL XH-1000 EXTRA HEAVY RIGID COUPLING

The **Shurjoint** Model XH-1000 is an extra heavy rigid coupling designed for high pressure services up to 1000 psi (70 Bar), supplied with a standard C-shaped gasket and heavy duty bolts and nuts. The coupling is painted in orange color. The Model XH-1000 can be installed on standard roll- or standard cut-grooved pipes. For sizes 2" through 4", there will be a gap between the bolts pads after installed and bolts and nuts shall be always tightened with a torque 60 – 70 Ft-Lbs (80-95 N-m). For sizes 6" and above, the bolt pads make a metal-to-metal contact when properly installed and there is no torque wrench requirement. The Model XH-1000 can be also used for stainless steel pipe.

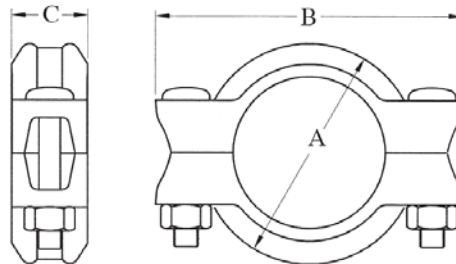

Full warranty terms can be found on www.shurjoint.com

Model XH-1000 Extra Heavy Rigid Coupling												
Nominal Size	Pipe OD	Max. Working Pressure (CWP)*	ASME/ANSI Pressure Class Rating [^]	Max. End Load (CWP)	Axial Displacement †	Dimensions			Bolt		Weight	
						A	B	C	No.	Size		
in mm	in mm	PSI Bar	PSI Nom. Class	Lbs kN	in mm	in mm	in mm	in mm	in mm	Lbs Kgs		
2 50	2.375 60.3	1000 69	1000 400	4420 19.98	0 ~ 0.14 0 ~ 3.6	3.50 90	5.90 150	1.92 49	2	5/8 x 2 3/4	3.4 1.6	
2 1/2 65	2.875 73.0	1000 69	1000 400	6480 29.28	0 ~ 0.14 0 ~ 3.6	4.02 102	6.61 168	1.92 49	2	5/8 x 2 3/4	3.8 1.7	
3 80	3.500 88.9	1000 69	1000 400	9610 43.43	0 ~ 0.14 0 ~ 3.6	4.86 123	7.40 188	1.92 49	2	5/8 x 2 3/4	4.8 2.2	
4 100	4.500 114.3	1000 69	1000 400	15890 71.79	0 ~ 0.25 0 ~ 6.4	6.09 155	8.74 222	2.10 53	2	3/4 x 4 3/4	8.4 3.8	
6 150	6.625 168.3	1000 69	1000 400	34450 155.65	0 ~ 0.25 0 ~ 6.4	8.58 218	11.61 295	2.25 57	2	7/8 x 5 5/8	17.6 8.0	
8 200	8.625 219.1	800 55	750 300	46710 207.26	0 ~ 0.25 0 ~ 6.4	10.83 275	14.33 364	2.75 70	2	1 x 5 1/2	24.0 10.9	
10 250	10.750 273.0	800 55	750 300	72570 321.78	0 ~ 0.25 0 ~ 6.4	13.15 334	16.70 424	2.95 75	2	1 x 5 1/2	31.2 14.2	
12 300	12.750 323.9	800 55	750 300	102080 452.95	0 ~ 0.25 0 ~ 6.4	15.35 390	18.90 480	2.95 75	2	1 x 5 1/2	36.7 16.7	

* Working Pressure is based on roll grooved standard wall carbon steel pipe.

[^] The ASME/ANSI pressure class rating is not the design or maximum pressure rating, rather is provided for those that are accustomed to specifying or using ASME/ANSI pressure class rated components such as flange, valves, etc.

† Allowable Axial Displacement and Angular Movement (deflection) figures are for roll grooved standard steel pipe. Values for cut grooved pipe will be double that of roll grooved. These values are maximums; for design and installation purposes these figures should be reduced by: 50% for 3/4" – 3 1/2"; 25% for 4" and larger to compensate for jobsite conditions.



Sizes 2" through 4" require a bolt torque of 60 – 70 Ft-Lbs (80 – 95 N-m). Normally you can see some gaps between the bolt pads. Bolt pad gaps should be equal on both sides of the coupling.

Sizes 6" through 12" are designed to make a metal-to-metal contact when properly installed.

Performance Data

The following tables show the maximum working pressures (CWP) of **Shurjoint** Model XH-1000 Extra Heavy Rigid Coupling used on both carbon steel and stainless steel pipes. **Shurjoint** ductile iron couplings can be used in conjunction with stainless steel pipe in non-corrosive environment as the flow media does not come in direct contact with the coupling housings but rather only the gasket.

Model XH-1000 on Carbon Steel Pipe					
Nom. Size in / mm	Cut-Grooved		Roll-Grooved		
	XS PSI / Bar	STD PSI / Bar	STD PSI / Bar	Sch. 10 PSI / Bar	Sch. 7 PSI / Bar
2 50	1500 103	1000 69	1000 69	750 52	NR
2½ 65	1500 103	1000 69	1000 69	600 42	NR
3 80	1500 103	1000 69	1000 69	600 42	NR
4 100	1500 103	1000 69	1000 69	600 42	NR
6 150	1500 103	1000 69	1000 69	450 31	NR
8 200	900 62	800 55	800 55	300 20	NR
10 250	900 62	800 55	800 55	300 20	NR
12 300	900 62	800 55	800 55	200 14	NR

Model XH-1000 on Stainless Steel Pipe					
Nom. Size in / mm	Cut-Grooved		Roll-Grooved		
	Sch. 80S PSI / Bar	Sch. 40S PSI / Bar	Sch. 40S PSI / Bar	Sch. 10S PSI / Bar	Sch. 5S PSI / Bar
2 50	1500 103	1000 69	750 52	500 35	NR
2½ 65	1500 103	1000 69	750 52	500 35	NR
3 80	1500 103	1000 69	750 52	500 35	NR
4 100	1500 103	1000 69	750 52	400 28	NR
6 150	1500 103	1000 69	500 35	200 14	NR
8 200	900 62	800 55	400 28	125 9	NR
10 250	900 62	800 55	400 28	125 9	NR
12 300	900 62	800 55	400 28	125 9	NR

MATERIAL SPECIFICATIONS

• Housing:

Ductile Iron to ASTM A536, Gr. 65-45-12 and or ASTM A395, Gr. 65-45-15, min. tensile strength 65,000 psi (448 MPa).

• Surface Finish:

Orange painted

Option: Green painted

• Rubber Gasket:

Grade "T" Nitrile C-shaped standard gasket (Color code: Orange stripe). Recommended for petroleum products, air with oil vapors, vegetable and mineral oils within the specified temperature range. Also good for water services under +150°F (+66°C).

Temperature range: -20°F to +180°F (-29°C to +82°C).

Do not use for HOT WATER above +150°F (+66°C) or HOT DRY AIR above +140°F (+60°C)

- Other options: Grade "E" - EPDM.
Grade "O" - Fluoroelastomer.
Grade "L" - Silicone.

For additional details contact **Shurjoint**.

• Bolts & Nuts:

Heat treated carbon manganese steel track bolts to ASTM A449-83a (or A183 Gr. 2), minimum tensile strength 110,000 psi (758 MPa), Zinc electroplated, with heavy-duty hexagonal nuts to ASTM A563.

General Notes:

- **ASME/ANSI Pressure-Temperature Rating** is provided as an aid in selecting a proper coupling to incorporate with other piping components (valves, flanges, and etc.) that are used in the same system and carry the ASME/ANSI rating. Select a Class 150 coupling to incorporate with Class 150 valves and flanges.
- **Maximum Working Pressure (CWP)** listed is the maximum cold water pressure for general piping services tested to ASTM F1476 and or AWWA C606 methods. Figures listed are based on roll- or cut-grooved standard wall carbon steel pipe. For other pipe schedules or pipe materials, contact **Shurjoint** for additional information.
- **Max. End Load** is calculated based on the maximum working pressure (CWP).
- **Field Joint Test:** For one time only the system may be tested hydrostatically at 1½ times the maximum working pressure listed (AWWA C606 5.2.3).
- **Warning:** Piping systems must always be depressurized and drained before attempting disassembly and or removal of any components.
- **The 10 Year Limited Warranty** applies to manufacturing defects only and does not cover severe service/temperature applications or wear parts.
- **Shurjoint** reserves the right to change specifications, designs and or standard without notice and without incurring any obligations.

Job Name:	System No.	Location:
Contractor:	Approved:	Date:
Engineer:	Approved:	Date:

Shurjoint product specifications in U.S. customary units and metric are approximate and are provided for reference only. For precise measurements, please contact **Shurjoint** Technical Service. **Shurjoint** reserves the right to change or modify product design, construction, specifications, or materials without prior notice and without incurring any obligations to make such changes and modifications on **Shurjoint** products previously subsequently sold.