

MODEL SS-1200 STAINLESS STEEL HIGH PRESSURE FLEXIBLE COUPLING

The Model SS-1200 is designed for high pressure applications including reverse osmosis, desalination and other specialty systems. The SS-1200 is available in strong and anti-corrosive alloys of Duplex CD3MN (2205), Super Duplex CE8MN, CE3MN (2507) and 6-Moly stainless steel CK3MNCuN (254SMO)*. The SS-1200 features 316 bolts, washers and silicon bronze nuts to help prevent galling during repetitive use.

* 254SMO is a registered trademark of Avesta Polaris AB.



SS-1200 couplings should always be installed so that the coupling bolt pads make metal to metal contact.

The **Shurjoint** Fast-Fit gasket has been designed and engineered for easier and faster installations. The pipe-end friendly design eliminates struggling to stretch the gasket over the pipe ends and the Fast-Fit gasket also features **Shurjoint's** Gap-Seal technology, which seals the gap between the pipe ends and eliminates stagnant water pockets within the gasket cavity. The Fast-Fit gasket is UL classified in accordance with ANSI/NSF 61 for potable water (Cold Water +86°F / 30°C and Hot Water +180°F / +82°C).

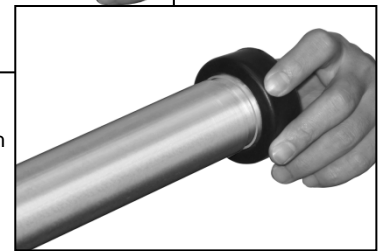
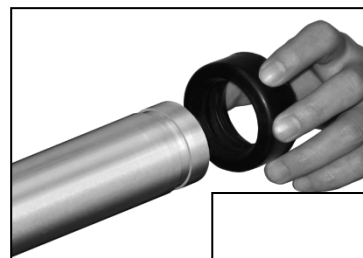

Fast-Fit Gasket:
Easy installation with a single hand



Always use the factory supplied **Shurjoint** Fast-Fit gasket. Performance standards do not support the use of a standard gasket in the SS-1200 coupling.

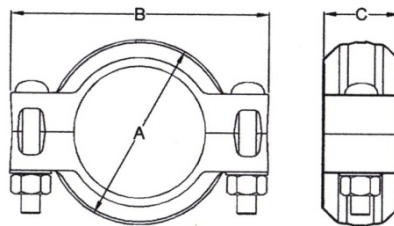

Full warranty terms can be found on www.shurjoint.com

Model SS-1200 Stainless Steel High Pressure Flexible Coupling

Nominal Size	Pipe OD	Max. Working Pressure (CWP)*	Max. End Load	Axial Displacement †	Dimensions			Deflection Degree†	Bolt No.	Size	Weight
					A	B	C				
3/4 <i>mm</i>	1.050 <i>mm</i>	1200 <i>PSI</i> 84 <i>Bar</i>	1040 <i>Lbs</i> 4.62 <i>kN</i>	0 - 0.06 <i>in</i> 0 - 1.6 <i>mm</i>	2.09 <i>in</i> 53 <i>mm</i>	3.70 <i>in</i> 94 <i>mm</i>	1.81 <i>in</i> 46 <i>mm</i>	3° - 23'	2	3/8 x 2 1/2	0.99 <i>Lbs</i> 0.45 <i>Kgs</i>
1 <i>in</i>	1.315 <i>in</i>	1200 <i>PSI</i> 84 <i>Bar</i>	1630 <i>Lbs</i> 7.25 <i>kN</i>	0 - 0.06 <i>in</i> 0 - 1.6 <i>mm</i>	2.36 <i>in</i> 60 <i>mm</i>	3.98 <i>in</i> 101 <i>mm</i>	1.81 <i>in</i> 46 <i>mm</i>	2° - 45'	2	3/8 x 2 1/2	1.21 <i>Lbs</i> 0.55 <i>Kgs</i>
1 1/4 <i>in</i>	1.660 <i>in</i>	1200 <i>PSI</i> 84 <i>Bar</i>	2595 <i>Lbs</i> 11.55 <i>kN</i>	0 - 0.06 <i>in</i> 0 - 1.6 <i>mm</i>	2.76 <i>in</i> 70 <i>mm</i>	4.37 <i>in</i> 111 <i>mm</i>	1.81 <i>in</i> 46 <i>mm</i>	2° - 10'	2	3/8 x 2 1/2	1.39 <i>Lbs</i> 0.63 <i>Kgs</i>
1 1/2 <i>in</i>	1.900 <i>in</i>	1200 <i>PSI</i> 84 <i>Bar</i>	3400 <i>Lbs</i> 15.13 <i>kN</i>	0 - 0.06 <i>in</i> 0 - 1.6 <i>mm</i>	2.99 <i>in</i> 76 <i>mm</i>	4.61 <i>in</i> 117 <i>mm</i>	1.81 <i>in</i> 46 <i>mm</i>	1° - 54'	2	3/8 x 2 1/2	1.54 <i>Lbs</i> 0.70 <i>Kgs</i>
2 <i>in</i>	2.375 <i>in</i>	1200 <i>PSI</i> 84 <i>Bar</i>	5315 <i>Lbs</i> 23.64 <i>kN</i>	0 - 0.06 <i>in</i> 0 - 1.6 <i>mm</i>	3.46 <i>in</i> 88 <i>mm</i>	5.39 <i>in</i> 137 <i>mm</i>	1.85 <i>in</i> 49 <i>mm</i>	1° - 31'	2	1/2 x 3	2.29 <i>Lbs</i> 1.04 <i>Kgs</i>
76.1 mm <i>mm</i>	3.000 <i>in</i> 76.1 <i>mm</i>	1200 <i>PSI</i> 84 <i>Bar</i>	8470 <i>Lbs</i> 38.19 <i>kN</i>	0 - 0.06 <i>in</i> 0 - 1.6 <i>mm</i>	4.01 <i>in</i> 102 <i>mm</i>	6.04 <i>in</i> 153 <i>mm</i>	1.91 <i>in</i> 49 <i>mm</i>	1° - 15'	2	1/2 x 3	3.04 <i>Lbs</i> 1.38 <i>Kgs</i>

Model SS-1200 Stainless Steel High Pressure Flexible Coupling

Nominal Size	Pipe OD	Max. Working Pressure (CWP)*	Max. End Load	Axial Displacement †	Dimensions			Deflection Degree†	Bolt No.	Size	Weight
					A	B	C				
in mm	in mm	PSI Bar	Lbs kN	in mm	in mm	in mm	in mm	(°)		in	Lbs Kgs
3 80	3.500 88.9	1200 84	11540 51.33	0 - 0.06 0 - 1.6	4.69 119	6.61 168	1.85 49	1° - 02'	2	½ x 3	3.41 1.55
4 100	4.500 114.3	1200 84	19075 84.86	0 - 0.13 0 - 3.2	5.98 152	8.15 207	2.03 52	1° - 36'	2	¾ x 3½	4.69 2.13

* The working pressure shown is based on cut-grooved Sch. 40S or 80S pipe only.

† Allowable Axial Displacement and Angular Movement (deflection) figures are for roll grooved standard steel pipe. Values for cut grooved pipe will be double that of roll grooved. These values are maximums; for design and installation purposes these figures should be reduced by: 50% for ¾"/DN20 – 3½"/DN90; 25% for 4"/DN100 and larger to compensate for jobsite conditions.

MATERIAL SPECIFICATIONS

• Housings:

Super duplex 2507 (CE3MN) to ASTM A890 Grade 5A

- Duplex 2205 (CD3MN) to ASTM Grade 4A
- Austenitic 254SMO (CK3MCuN) to A743

• Rubber Gaskets:

Gr. E-pw EPDM (Color code: Double Green Strips), Good for cold +86°F (+30°C) and hot +180°F (+82°C) potable water services. EPDM is UL classified per ANSI/NSF 61.

- Grade "E" EPDM (Color code: Green stripe), certified under ANSI / NSF 61 for potable water use, good for cold & hot water up to +230°F (+110°C). Also good for services for water with acid, water with chlorine, deionized water, seawater and waste water, dilute acids, oil-free air and many chemicals.

Not recommended for petroleum oils, minerals oils, solvents and aromatic hydrocarbons.

Maximum Temperature Range: -29°F (-34°C) to +230°F (+110°C)*.

*EPDM gaskets for water services are not recommended for steam services unless couplings or components are accessible for frequent gasket replacement.

• Bolts:

Type 316 stainless steel track bolts to ASTM A193 B-8M, Molybdenum disulfide (MoS₂) coated

• Nuts:

Silicon bronze heavy duty nuts to ASTM B98 C65100

• Washers:

Type 316 stainless steel

General Notes:

- **Maximum Working Pressure (CWP)** listed is the maximum cold water pressure for general piping services tested to ASTM F1476 and or AWWA C606 methods. Figures listed are based on roll- or cut-grooved standard wall carbon steel pipe. For other pipe schedules or pipe materials, contact **Shurjoint** for additional information.
- **Max. End Load** is calculated based on the maximum working pressure (CWP).
- **Field Joint Test:** For one time only the system may be tested hydrostatically at 1½ times the maximum working pressure listed (AWWA C606 5.2.3).
- **Warning:** Piping systems must always be depressurized and drained before attempting disassembly and or removal of any components.
- **The 10 Year Limited Warranty** applies to manufacturing defects only and does not cover severe service/temperature applications or wear parts.
- **Shurjoint** reserves the right to change specifications, designs and or standard without notice and without incurring any obligations.

Job Name:	System No.	Location:
Contractor:	Approved:	Date:
Engineer:	Approved:	Date:

Shurjoint product specifications in U.S. customary units and metric are approximate and are provided for reference only. For precise measurements, please contact **Shurjoint** Technical Service. **Shurjoint** reserves the right to change or modify product design, construction, specifications, or materials without prior notice and without incurring any obligations to make such changes and modifications on **Shurjoint** products previously subsequently sold.